

配線端子插頭(DIN43650)

- 種類：
1. 標準插頭
 2. 附燈插頭
 3. 保護迴路附燈插頭

閥桿

閥桿經特殊鏡面加工及硬質膜處理



線圈種類

1. AC110V 50 / 60Hz
2. AC220V 50 / 60Hz
3. DC 12V
4. DC 24V

正常使用5000萬次以上壽命，能長時間作動不燒損。

VE系列改良型，密封件固定壽命，比密封件移動方式更長。





規格

系列	VEC1000	VEC2000	VEC3000
使用流體	乾燥空氣		
操作壓力範圍	0.17~0.8MPa(1.7~8kgf/cm ²)		
耐壓力	1.0MPa(10kgf/cm ²)		
使用溫度	5°C~60°C (41°F~140°F)		
潤滑給油	潤滑或不潤滑		
反應靈敏度	0.05秒		
適用氣缸範圍	Ø12~Ø40mm	Ø40~Ø63mm	Ø63~Ø100mm
負載週期	100% ED		
配線端子	歐規標準配線插頭 DIN 43650		
電壓範圍	± 10%		
保護結構	IP65 防水/防塵		
絕緣等級	F級		
溫度範圍	30°C (86°F)		
消耗電力	DC24V:2.5W AC110V 50Hz:4.8VA AC110V 60Hz:4VA	DC24V:3W AC110V/220V 50Hz:6.0VA AC110V/220V 60Hz:4.9VA AC24V 60Hz:6.4VA	DC24V:5.5W AC110V 50Hz:8.4VA AC110V 60Hz:6.8VA AC120V 60Hz:8.8VA AC220V 50Hz:8.5VA AC220V 60Hz:6.9VA AC24V 60Hz:8.5VA

系列	切換方式		接管口徑		有效斷面積	重量
			R,S	P,A,B	P→A/B	
VEC1000	五口二位	單線圈	G1/8"	G1/8"	12mm ² (0.67CV)	100g
		雙線圈				150g
	五口三位	中位關閉			9mm ² (0.5CV)	170g
		中位開放				
中位壓力						
三口二位	常閉型	12mm ² (0.67CV)	90g			
VEC2000	五口二位	單線圈	G1/8"	G1/4"	18mm ² (1CV)	180g
		雙線圈				270g
	五口三位	中位關閉			12mm ² (0.7CV)	310g
		中位開放				
中位壓力						
三口二位	常閉型	18mm ² (1CV)	170g			
VEC3000	五口二位	單線圈	G1/4"	G3/8"	30mm ² (1.68CV)	260g
		雙線圈				300g
	五口三位	中位關閉			22mm ² (1.2CV)	310g
		中位開放				
中位壓力						
三口二位	常閉型	30mm ² (1.68CV)	245g			

表示方法

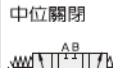
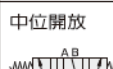
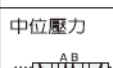
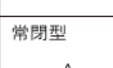
系列	型號	作動方式	配管口徑	配管方式	線圈電壓	插頭規格	連座數							
VEC	1	1	1	0	A11	L	M2							
								1 1000	單線圈 1 	1 G1/8" (1000用)	0 沒有底座	A11 AC110V 50/60Hz	空 標準插頭 DIN 43650	M2 2連
								2 2000	雙線圈 2 	2 G1/4" (2000用)	1 連座式	A22 AC220V 50/60Hz	L 附燈插頭 DIN 43650	⋮
								3 3000	中位關閉 3 	3 G3/8" (3000用)		A24 AC24V	S 保護迴路 附燈插頭 DIN 43650	M10 10連
									中位開放 4 			D12 DC12V		
									中位壓力 5 			D24 DC24V		
	常閉型 6 													

外形尺寸圖

● VEC1110 單線圈

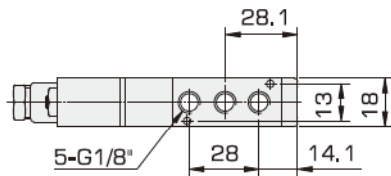
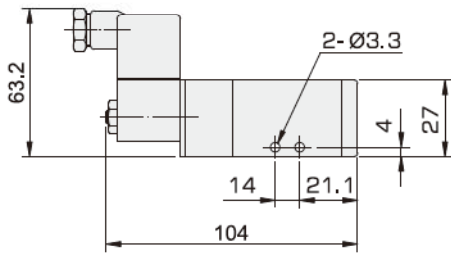
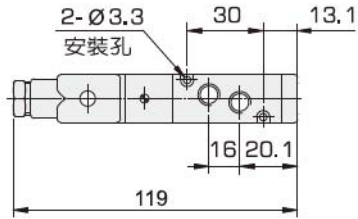
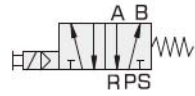

● VEC1210 雙線圈

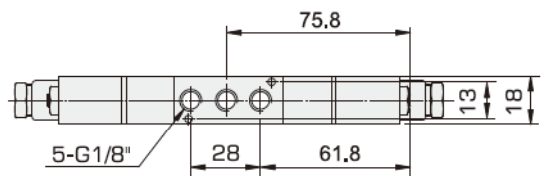
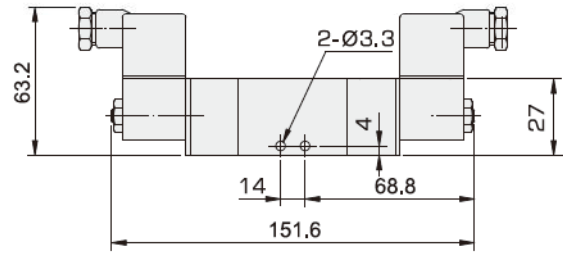
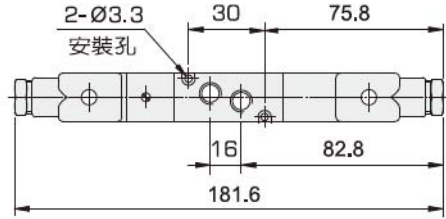
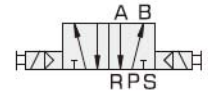

● VEC1310 中位關閉

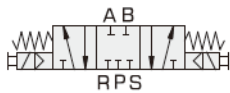

● VEC1410 中位開放



● VEC1510 中位壓力

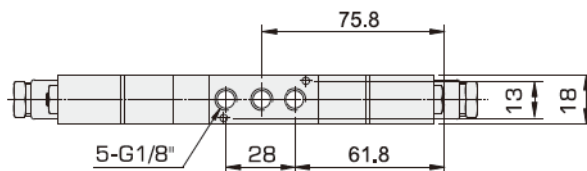
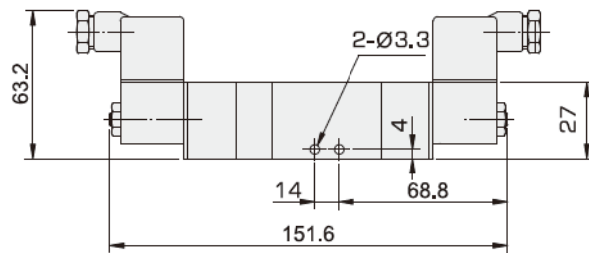
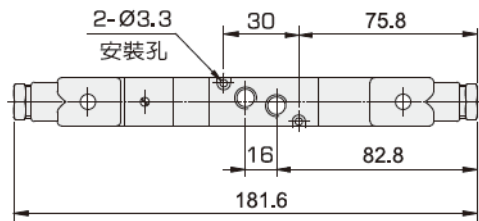

外形尺寸圖

● VEC1610 常閉型

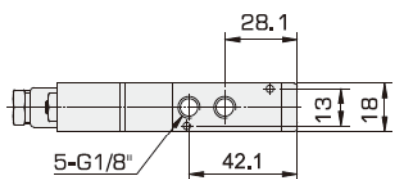
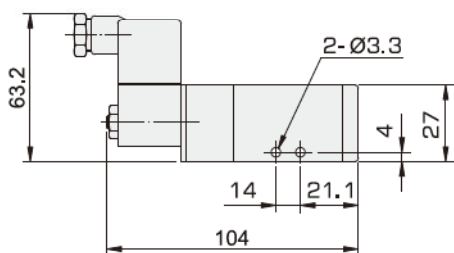
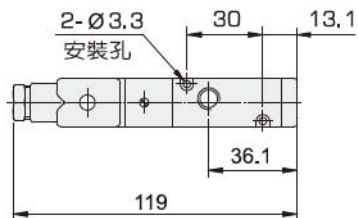
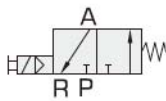

● VEC2120 單線圈

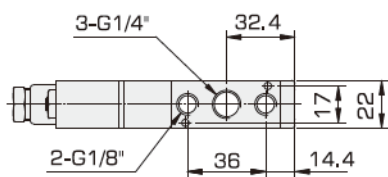
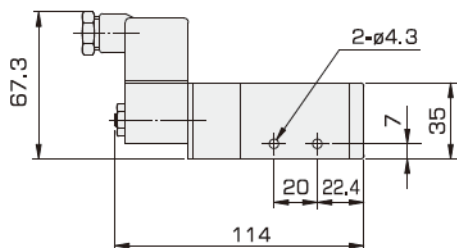
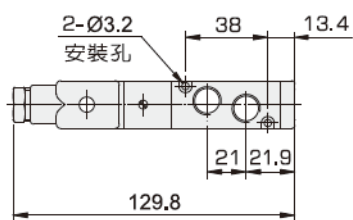

● VEC2220 雙線圈

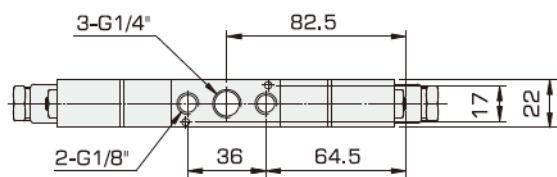
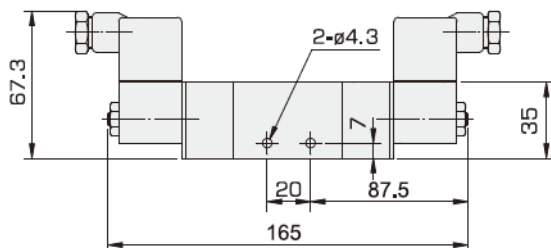
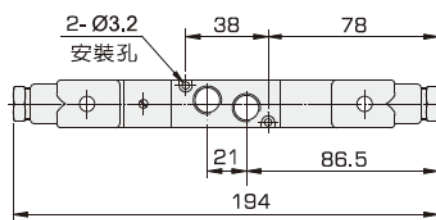

外形尺寸圖

● VEC2320 中位關閉

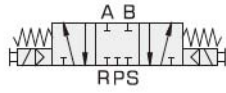

● VEC2420 中位開放

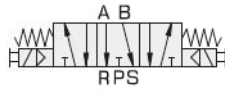

● VEC2520 中位壓力

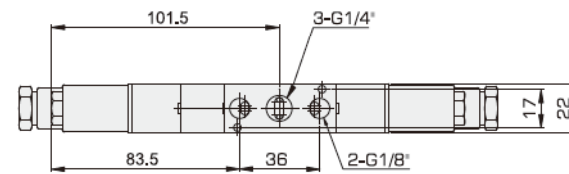
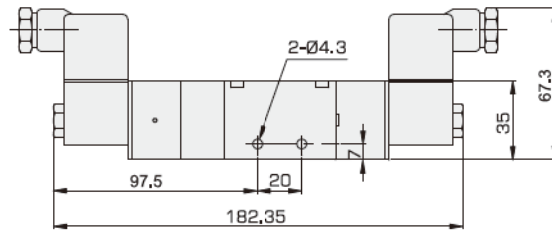
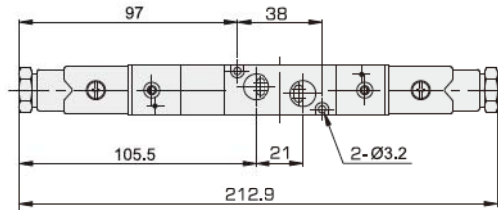

● VEC2620 常閉型

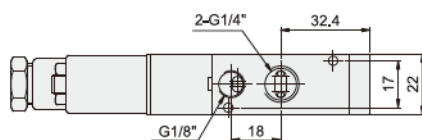
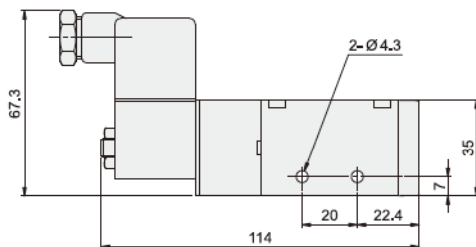
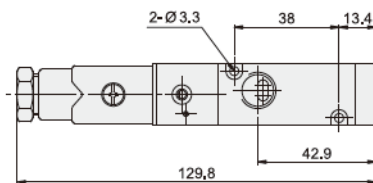
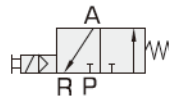

外形尺寸圖

● VEC3130 單線圈

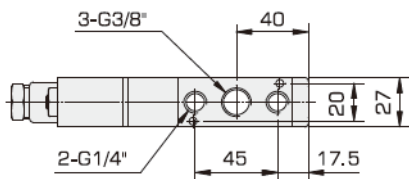
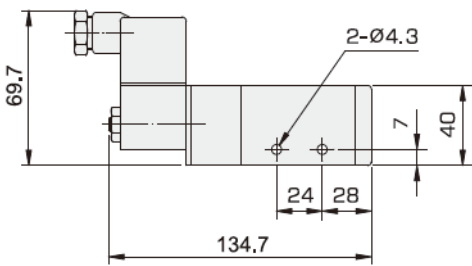
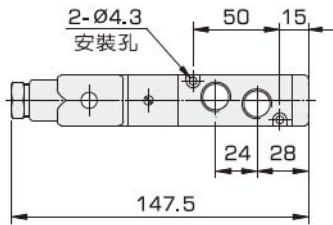

● VEC3230 雙線圈

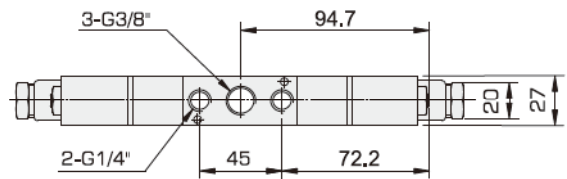
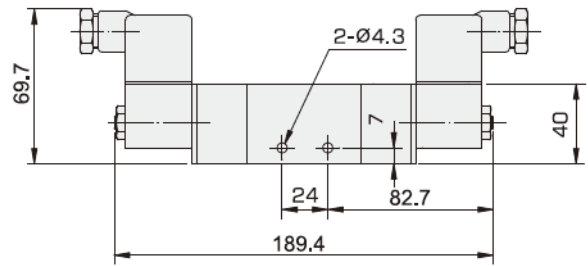
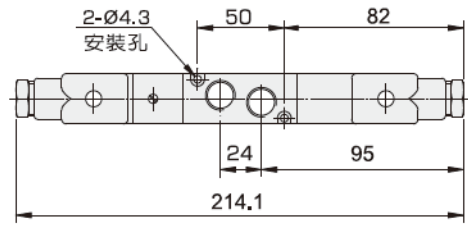

● VEC3330 中位關閉

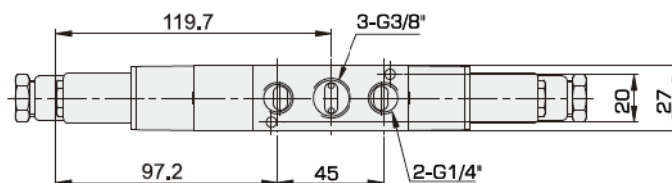
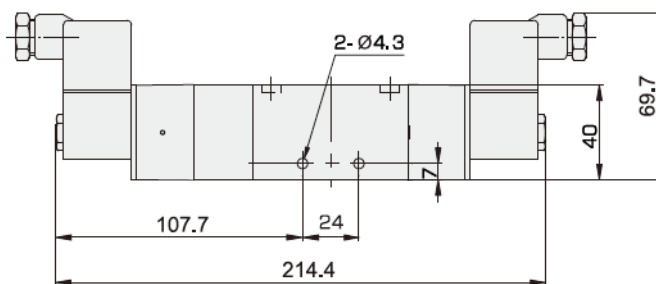
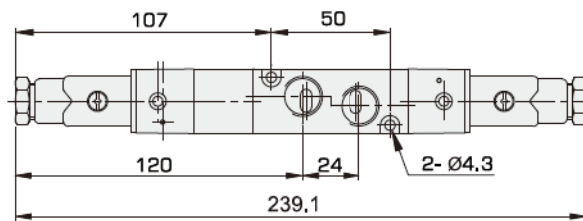
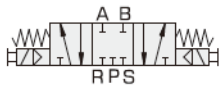

● VEC3430 中位開放



● VEC3530 中位壓力



外形尺寸圖

● VEC3630 常閉型

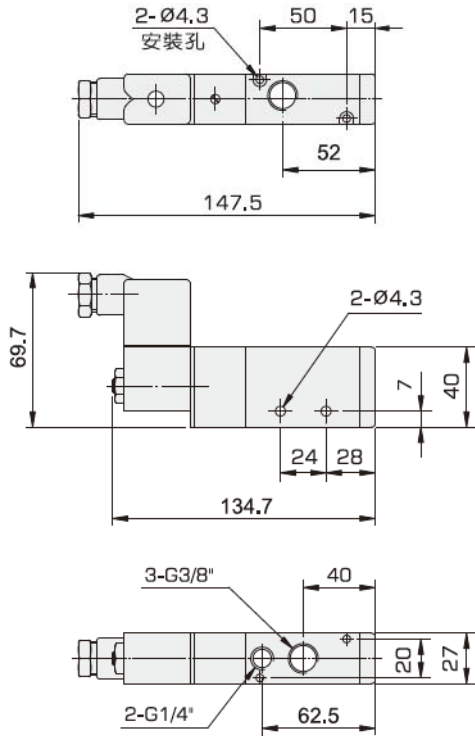
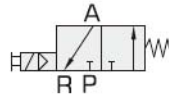

連座外形尺寸表

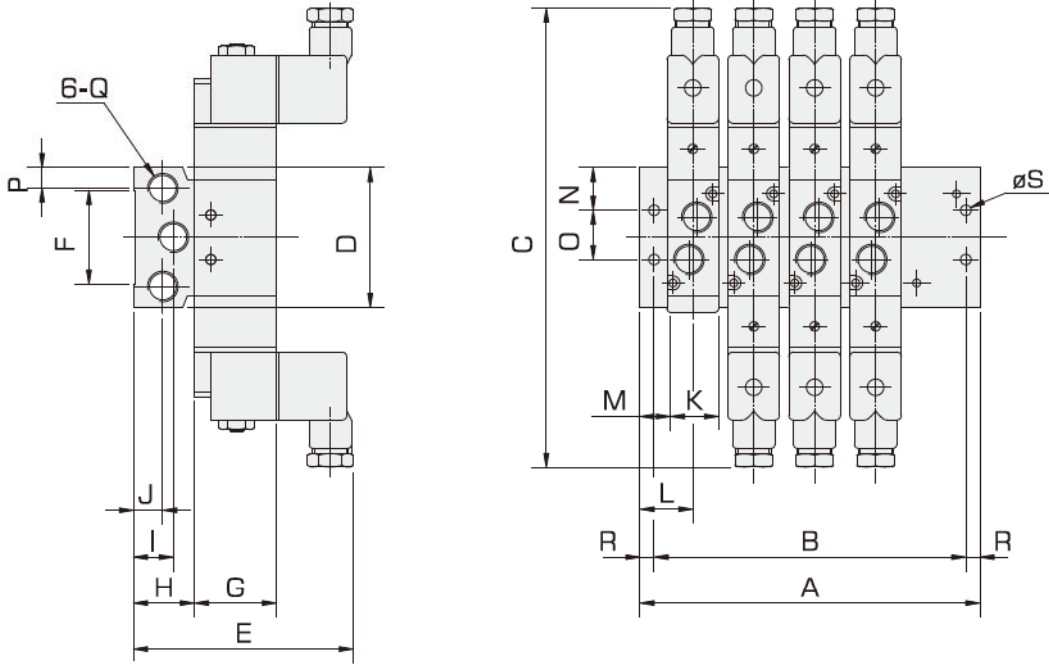

系列	C	D	E	F	G	H	I	J	K	L	M	N	O	P	Q	R	ØS
VEC1	181.6	58	88.2	36	27	25	16	11	18	19	10	19	20	9	G1/4"	5	4.5
VEC2	194	65	94	33	35	26.5	16.5	12.5	22	23	12	21.5	21	11	G1/4"	6	5
VEC3	214.1	80	97.2	50	40	27.5	-	14.5	27	29	15.5	25.8	26	11.5	G3/8"	6	5

連座		M2	M3	M4	M5	M6	M7	M8	M9	M10
VA1	A	57	76	95	114	133	152	171	190	209
	B	47	66	85	104	123	142	161	180	199
VA2	A	69	92	115	138	161	184	207	230	253
	B	57	80	103	126	149	172	195	218	241
VA3	A	82	110	138	166	194	222	250	278	306
	B	70	98	126	154	182	210	238	266	294